

# Bead Roller Speed Adjustment Kit Instruction Manual

For Upgrading Models: 210-24NV, 200-36NV, 204-24NV, 204-36NV, 202-24NV, 202-36NV, 202-24NV-HT, & 202-36NV-HT  
Built Before 2014



***CAUTION: Read and Understand***

These Operating, Servicing, and Safety Instructions,  
Before Using This Machine.

10 Cooperative Way    Wright City, MO 63390  
P.O. Box 110    Foristell, MO 63348  
1-800-467-2464    1-636-745-7757    Fax 1-636-745-2874  
[www.mittlerbros.com](http://www.mittlerbros.com)

# FACEPLATE & POTENTIOMETER INSTALATION

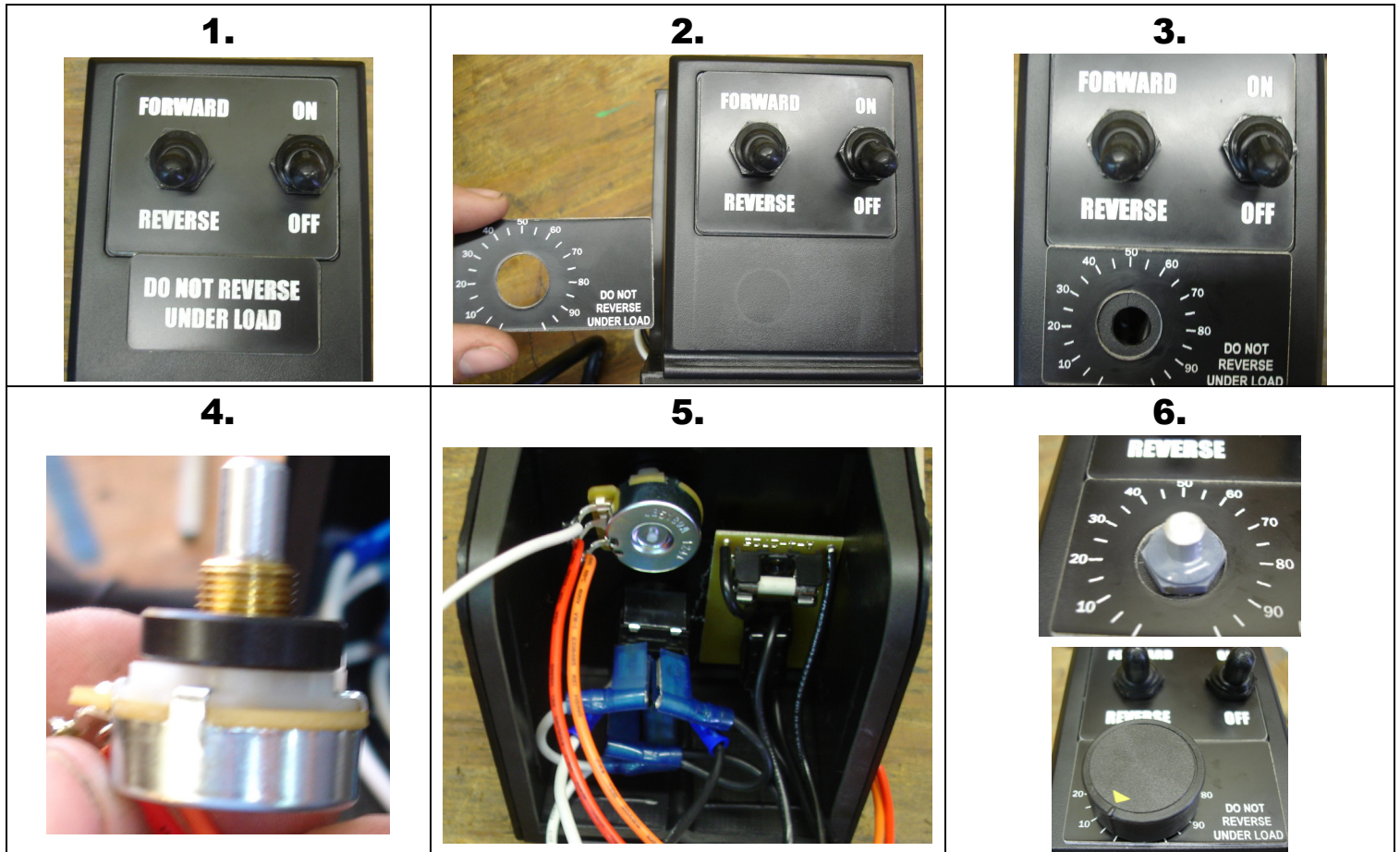

1. Unplug Machine
2. Remove Control Cover (One Screw)
3. Remove “Do Not Reverse Under Load” Faceplate (**Ref. Photo 1.**)
4. Install new Faceplate below original Faceplate (**Ref. Photo 2.**)
5. Find center of hole on the new Faceplate, Drill a 3/8” hole. (Be careful not to damage any electrical components) (**Ref. Photo 3.**)
6. Next take your new Potentiometer and find the set screw on the side of the Potentiometer Knob. Remove set screw and pull Knob straight up from Potentiometer.
7. Under the Potentiometer Knob should be a plastic nut, this needs to be removed as well.
8. With Knob and plastic nut removed you can now install the spacer washer onto the shaft of the Potentiometer. (**Ref. Photo 4.**)
9. Install the Potentiometer through the 3/8” hole in the faceplate. Make sure the soldered ends of the Potentiometer are facing to the left side of the control box. (**Ref. Photo 5.**)
10. Once Potentiometer is in the proper position you can thread on the plastic nut that you removed in Step 7. Don’t over tighten just snug nut down. (**Ref. Photo 6.**)
11. With your thumb and index finger twist the Potentiometer Shaft all the way Counter Clockwise until it stops
12. Replace Potentiometer Knob but make sure the yellow arrow is lined up Zero or the first line of the new Faceplate (**Ref. Photo 6.**) **Numbers on Faceplate are for Reference Only.**
13. After Knob is in place tighten the set screw

# WIRING INSTRUCTIONS

**1.**

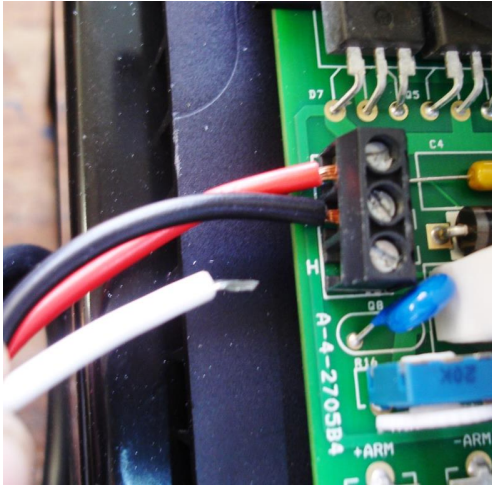

**2.**

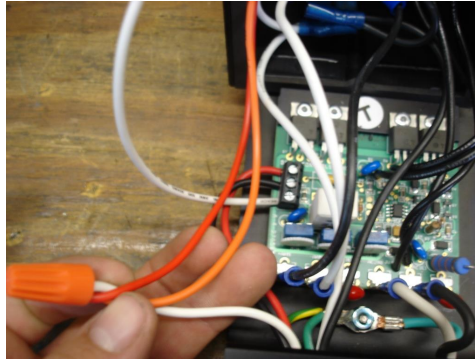

**3.**

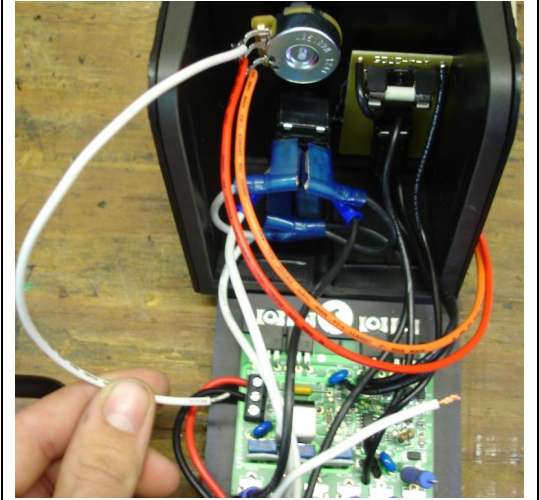

Look inside your control box at the electric panel and you will see 3 wires (Red, Black & White) coming from the Foot Pedal going to a Terminal Block on the electric panel. Then look at your Potentiometer and you will also see 3 wires (White, Red & Orange). This is where your work will be focused.

- 1.** Find the White Wire running from the Foot Pedal to the Terminal Block, loosen the screw and remove the wire. **(Ref. Photo 1.)**
- 2.** Wire Nut the White Wire from the Foot Pedal and the Red & Orange Wires from the Potentiometer together. Wrap electric tape around Wire Nut & Wires. **(Ref. Photo 2.)**
- 3.** Using the White Wire from the Potentiometer attach it to the Terminal Block (on electric panel) labeled H. Tighten screw down on White Wire. **(Ref. Photo 3.)**
- 4.** Replace Cover, make sure all wires are inside cover and do not get pinched between cover & box.
- 5.** Machine is ready for use.

**Any Questions? Call 1-800-467-2464**  
**10 Cooperative Way Wright City, MO 63390**  
**P.O. Box 110 Foristell, MO 63348**  
**1-636-745-7757 Fax 1-636-745-2874**

**[www.mittlerbros.com](http://www.mittlerbros.com)**